

See Parts List for a complete listing of optional accessories.

Specifications on this page are subject to change without notice. Every attempt has been made to ensure the accuracy of this drawing; however, Traxas cannot be held responsible for typographical or other errors.

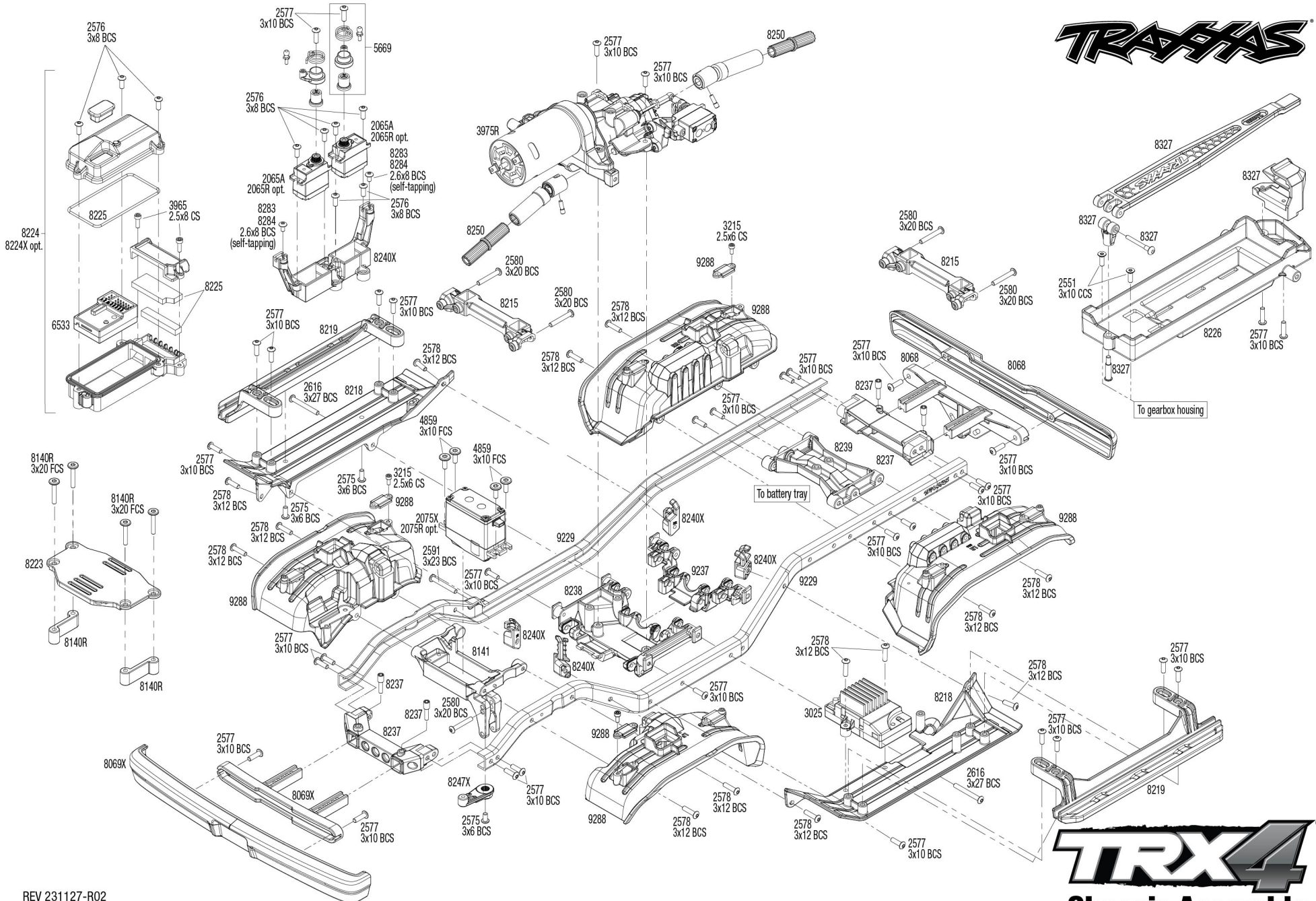

REV 231127-R02
See Parts List for a complete listing of optional accessories.

Specifications on this page are subject to change without notice. Every attempt has been made to ensure the accuracy of this drawing; however, Traxxas cannot be held responsible for typographical or other errors.



TRX4[®]

Front Assembly

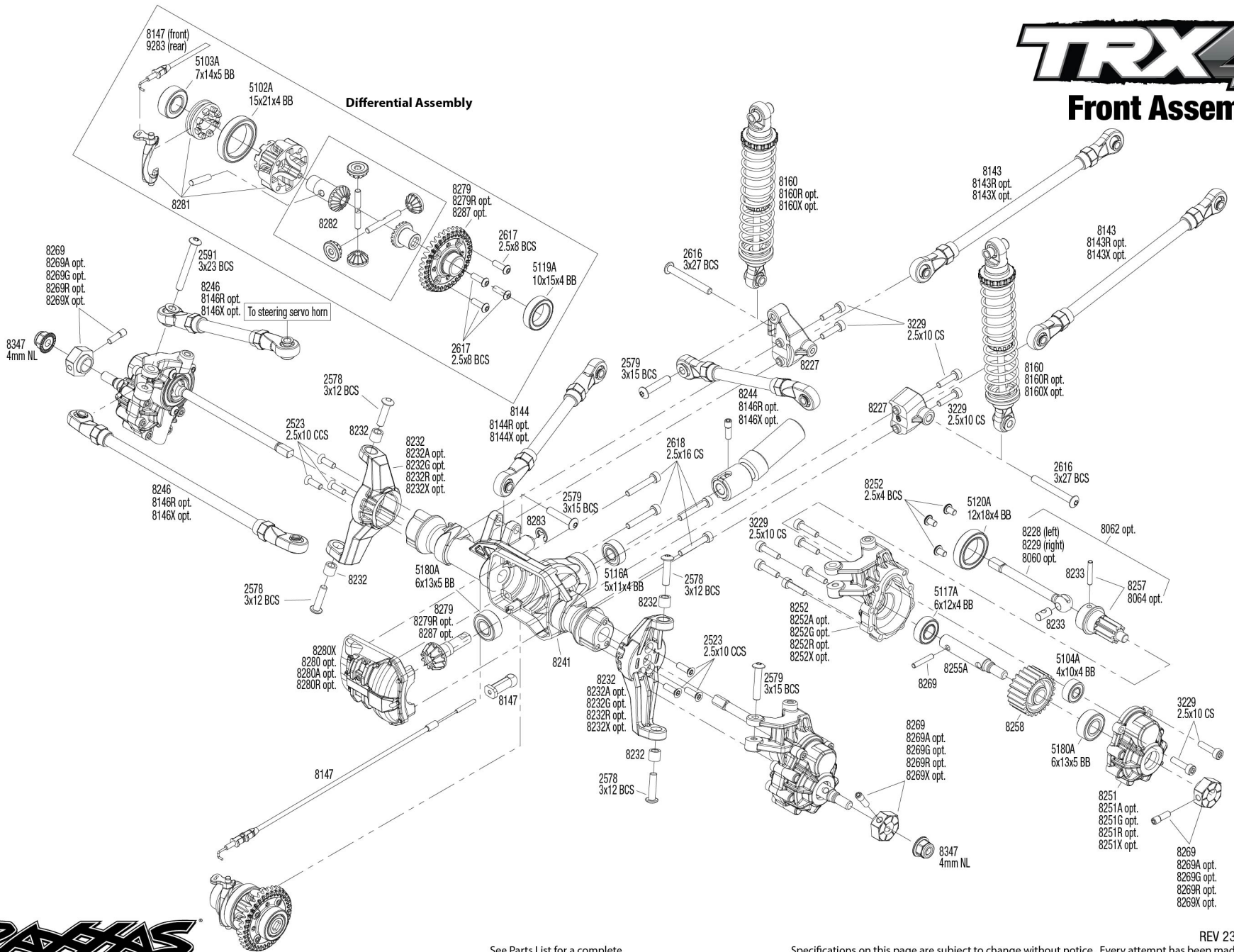

See Parts List for a complete listing of optional accessories.

Specifications on this page are subject to change without notice. Every attempt has been made to ensure the accuracy of this drawing; however, Traxxas cannot be held responsible for typographical or other errors.

REV 231127-R02

Link Dimensions

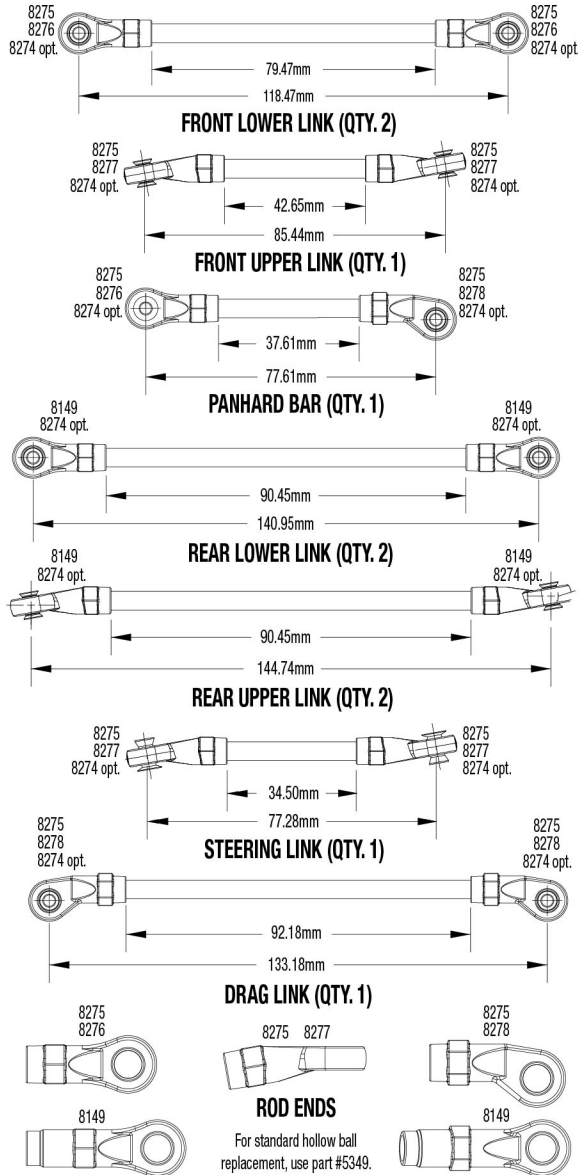

Modular Assembly

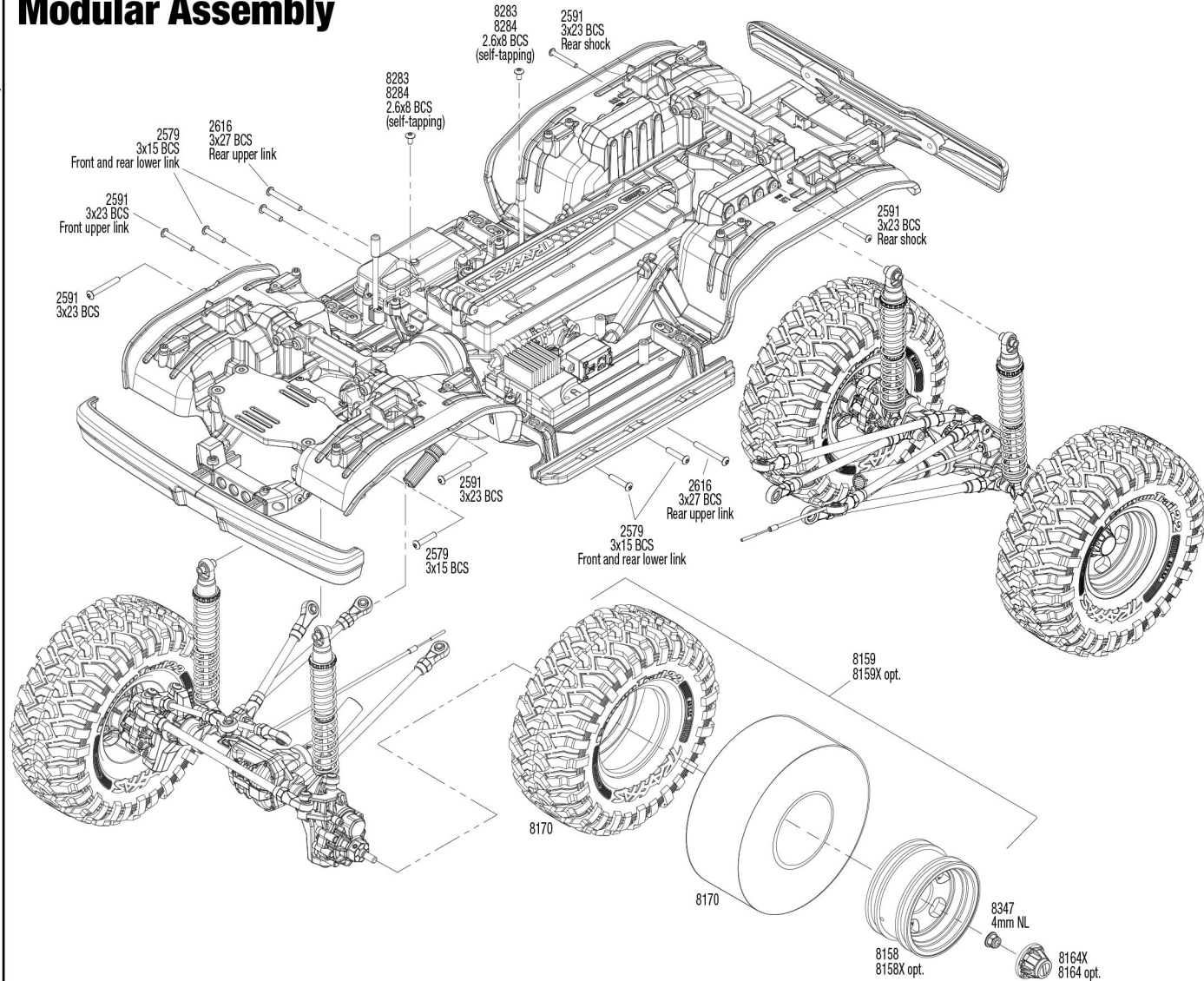

See Parts List for a complete listing of optional accessories.

Specifications on this page are subject to change without notice. Every attempt has been made to ensure the accuracy of this drawing; however, Traxxas cannot be held responsible for typographical or other errors.

Shock Assembly

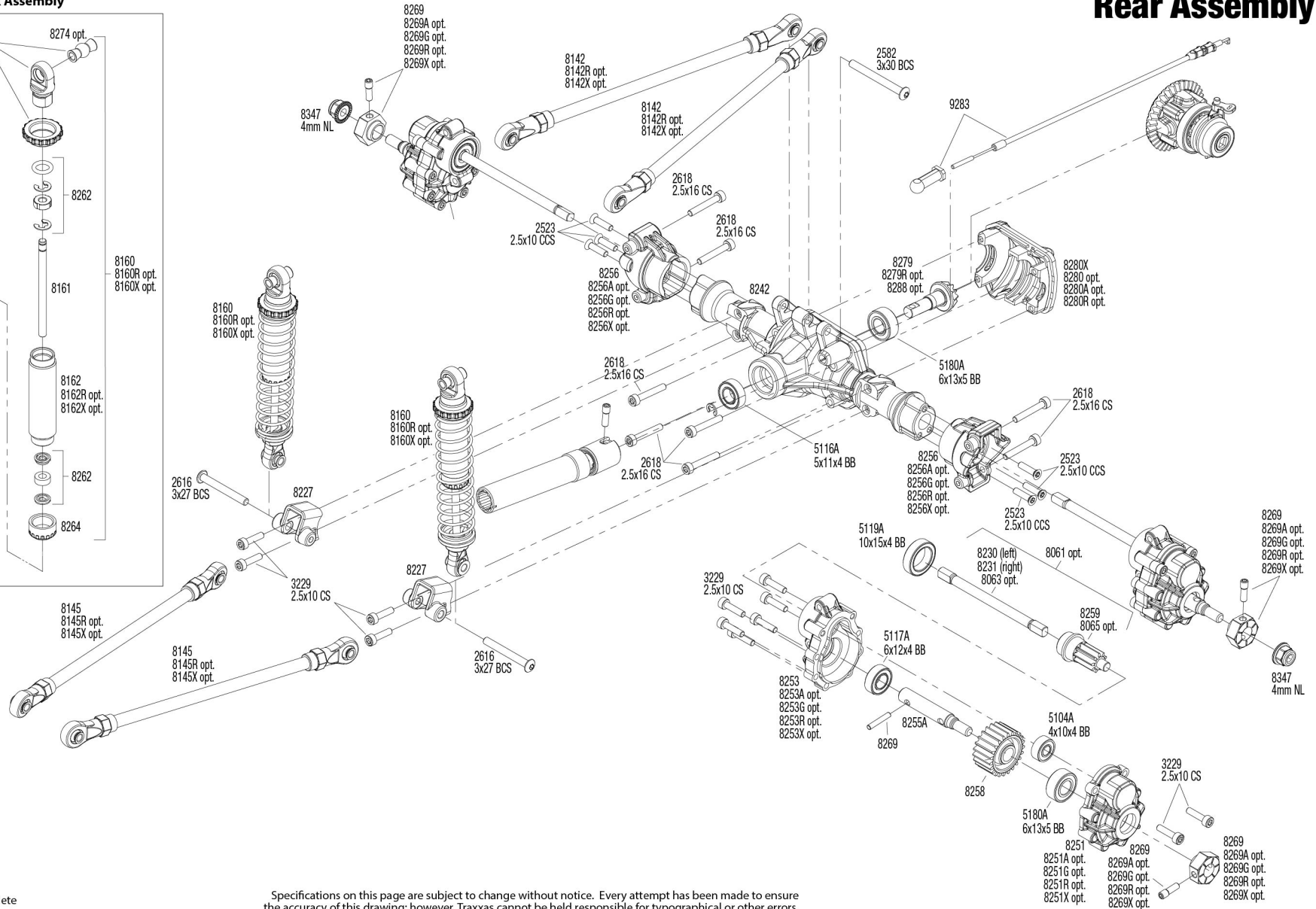
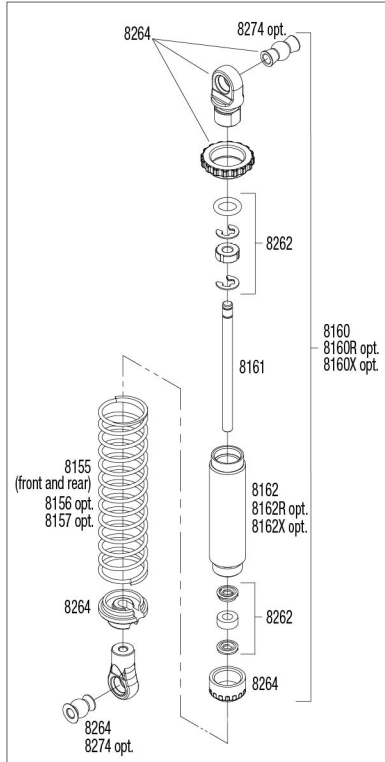



Driveshaft Length Indicators

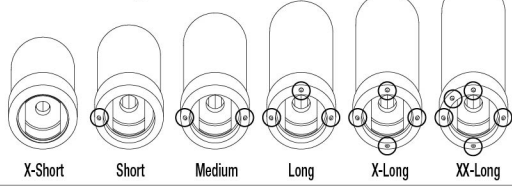

Transmission Assembly

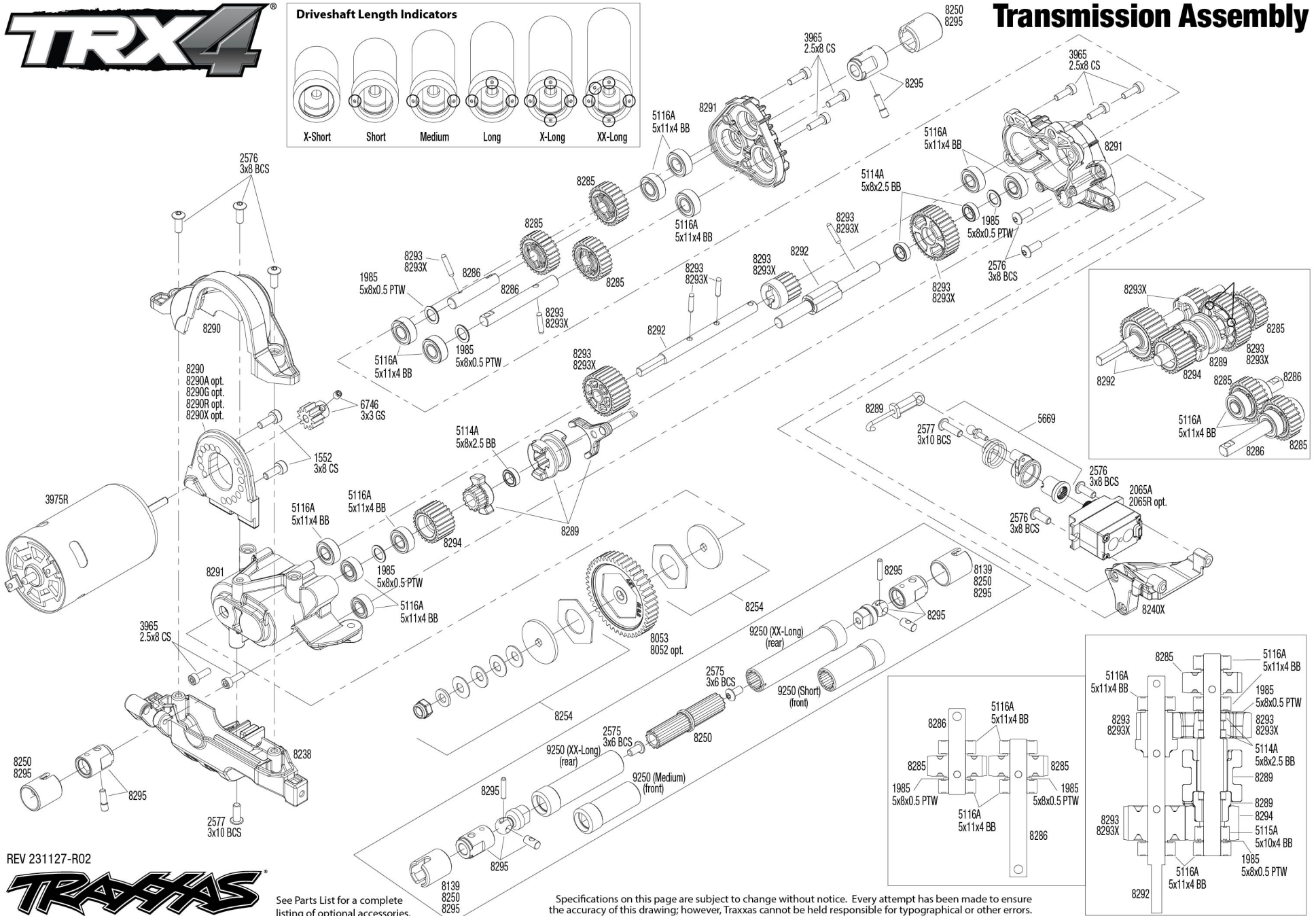

REV 231127-R02



See Parts List for a complete listing of optional accessories.

Specifications on this page are subject to change without notice. Every attempt has been made to ensure the accuracy of this drawing; however, Traxxas cannot be held responsible for typographical or other errors.



TRX-4® Ford® F-150® High Trail Edition™ (Model 92046-4) Parts List

Parts shown in bold are optional accessories. Part categories and individual part listings are arranged alphabetically.

Axle Components

8241	Axle housing, front
8242	Axle housing, intermediate (TRX-6™) or rear (TRX-4®)
8227	Axle mount set (complete) (front & rear) (for suspension links)
8228	Axle shaft, front (left)/ drive pin/ cross pin
8229	Axle shaft, front (right)/ drive pin/ cross pin
8060	Axle shaft, front, heavy duty (left & right) (requires #8064 front portal drive input gear)
8062	Axle shaft, front, heavy duty (left & right)/ portal drive input gear, front (machined) (2) (assembled)
8230	Axle shaft, rear (left)
8231	Axle shaft, rear (right)
8063	Axle shaft, rear, heavy duty (left & right) (requires #8065 rear portal drive input gear)
8061	Axle shaft, rear, heavy duty (left & right)/ portal drive input gear, rear (machined) (2) (assembled)
8147	Cable, T-lock (medium) (for use with TRX-4® Long Arm Lift Kit)
9283	Cable, T-lock, rear (185mm)
8233	Cross pin (2)/ drive pin (2) (to rebuild front axle shafts)
8256	Portal drive axle mount, rear (left & right)
8256X	Portal drive axle mount, rear, 6061-T6 aluminum (blue-anodized) (left and right)/ 2.5x16 CS (4)
8256A	Portal drive axle mount, rear, 6061-T6 aluminum (charcoal gray-anodized) (left and right)/ 2.5x16 CS (4)
8256G	Portal drive axle mount, rear, 6061-T6 aluminum (green-anodized) (left and right)/ 2.5x16 CS (4)
8256R	Portal drive axle mount, rear, 6061-T6 aluminum (red-anodized) (left and right)/ 2.5x16 CS (4)
8252	Portal drive housing, inner, front (left & right)/ 2.5x4 BCS (6)
8253	Portal drive housing, inner, rear (left or right) (2)
8251	Portal drive housing, outer (front or rear) (2)
8064	Portal drive input gear, front (machined) (left or right) (requires #8060 front axle shaft)
8257	Portal drive input gear, front/ drive pin/ cross pin
8259	Portal drive input gear, rear
8065	Portal drive input gear, rear (machined) (left or right) (requires #8063 rear axle)
8258	Portal drive output gear, front or rear
8252X	Portal housings, inner (front), 6061-T6 aluminum (blue-anodized) (2)/ 3x12 BCS (2)
8252A	Portal housings, inner (front), 6061-T6 aluminum (charcoal gray-anodized) (2)/ 3x12 BCS (2)
8252G	Portal housings, inner (front), 6061-T6 aluminum (green-anodized) (2)/ 3x12 BCS (2)
8252R	Portal housings, inner (front), 6061-T6 aluminum (red-anodized) (2)/ 3x12 BCS (2)
8253X	Portal housings, inner (rear), 6061-T6 aluminum (blue-anodized) (2)/ 2.5x10 CS (2)
8253A	Portal housings, inner (rear), 6061-T6 aluminum (charcoal gray-anodized) (2)/ 2.5x10 CS (2)
8253G	Portal housings, inner (rear), 6061-T6 aluminum (green-anodized) (2)/ 2.5x10 CS (2)
8253R	Portal housings, inner (rear), 6061-T6 aluminum (red-anodized) (2)/ 2.5x10 CS (2)
8251X	Portal housings, outer, 6061-T6 aluminum (blue-anodized) (2)/ 2.5x10 CS (12)
8251A	Portal housings, outer, 6061-T6 aluminum (charcoal gray-anodized) (2)/ 2.5x10 CS (12)
8251G	Portal housings, outer, 6061-T6 aluminum (green-anodized) (2)/ 2.5x10 CS (12)
8251R	Portal housings, outer, 6061-T6 aluminum (red-anodized) (2)/ 2.5x10 CS (12)
8255A	Stub axle, extended thread (portal drive) (2)
8267	Weight, portal housing, brass (2) (34 grams)/ 2.5x8 CS (6) (requires #8251X, #8251R, #8251A, or #8251G outer portal housing)

Bearings & Bushings

5119A	Ball bearings, black rubber sealed (10x15x4mm) (2)
5120A	Ball bearings, black rubber sealed (12x18x4mm) (2)
5102A	Ball bearings, black rubber sealed (15x21x4mm) (2)
5104A	Ball bearings, black rubber sealed (4x10x4mm) (2)
5115A	Ball bearings, black rubber sealed (5x10x4mm) (2)
5116A	Ball bearings, black rubber sealed (5x11x4mm) (2)
5114A	Ball bearings, black rubber sealed (5x8x2.5mm) (2)
5117A	Ball bearings, black rubber sealed (6x12x4mm) (2)

5180A	Ball bearings, black rubber sealed (6x13x5mm) (2)
5103A	Ball bearings, black rubber sealed (7x14x5mm) (2)

Body (1979 Chevrolet® K10 Truck)

9226	Body cage (fits #9212 body)
9228	Body mounts (front & rear)/ 3x10mm BCS (7) (fits #9212 body)
9212	Body, Chevrolet K10 Truck (1979) (clear, requires painting)/ decals/ window masks (includes grille, side mirrors, door handles, windshield wipers, clipless mounting, hardware) (requires #9288 inner fenders)
9212X	Body, Chevrolet K10 Truck (1979), complete, black (painted, decals applied) (includes grille, side mirrors, door handles, windshield wipers, front & rear bumpers, clipless mounting) (requires #9288 inner fenders)
9212R	Body, Chevrolet K10 Truck (1979), complete, red (painted, decals applied) (includes grille, side mirrors, door handles, windshield wipers, front & rear bumpers, clipless mounting) (requires #9288 inner fenders)
6593	Distribution block, Pro Scale® Advanced Lighting Control System
8134	Grille, Chevrolet Blazer or K10 Truck (1979)/ grille retainers (4)/ headlight housing (2)/ lens (2)/ 2.6x8 BCS (4)/ 2.5x6 BCS (2) (fits #8130 or 9212 series bodies)
8082	Installation kit, Pro Scale® Advanced Lighting Control System, TRX-4® Chevrolet Blazer or K10 Truck (1979) (includes mount, reverse lights harness, hardware)
8039	LED light set (contains headlights, tail lights, side marker lights, & distribution block) (fits #8130 series bodies, requires #8028 power supply)
8038	LED light set, complete with power supply (contains headlights, tail lights, side marker lights, & distribution block) (fits #8130 series bodies)
9263	Light bar, chrome (housing & lens only) (fits #9262 or 9262X roll bar)
6592	Power module, Pro Scale® Advanced Lighting Control System (includes mount, communication cables, hardware)
6591	Pro Scale® Advanced Lighting Control System (includes power module & distribution block)
8038X	Pro Scale® LED light set, TRX-4® Chevrolet Blazer or K10 Truck (1979), complete with power module (contains headlights, tail lights, side marker lights, & distribution block) (fits #8130 or 9212 series bodies)
6594	Receiver communication cable, Pro Scale® Advanced Lighting Control System
9262X	Roll bar (assembled with LED lights)/ mounts (front (2), rear (left & right)/ 2.6x12mm BCS (self-tapping) (4) (fits #9212 or 9230 series bodies)
9262	Roll bar/ mounts (front (2), rear (left & right)/ 2.6x12mm BCS (self-tapping) (4) (fits #9212 or 9230 series bodies)
8135	Tail lights, left & right (assembled)/ tail light retainers, left & right/ side marker lights (assembled) (2)/ side marker retainers (2)/ mounting tape (2)/ 1.6x5 BCS (self-tapping) (4)/ 2.6x8 BCS (2) (fits #8130 or 9212 series bodies)

Body (1979 Ford® F-150® Truck)

9233	Body cage, front & rear (fits #9230 body)
9234	Body mounts, front & rear (fits #9230 body)
9230	Body, Ford F-150 (1979) (clear, requires painting)/ decals/ window masks (includes grille, side mirrors, door handles, windshield wipers, clipless mounting, hardware) (requires #9288 inner fenders) (roll bar sold separately; choose #9262 chrome, 9262R black, or 9262X chrome with lights)
9230-BLK	Body, Ford F-150 (1979), complete, black (painted, decals applied) (includes grille, side mirrors, door handles, windshield wipers, front & rear bumpers, clipless mounting) (requires #9288 inner fenders) (roll bar sold separately; choose #9262 chrome, 9262R black, or 9262X chrome with lights)
9230-BLUE	Body, Ford F-150 (1979), complete, blue (painted, decals applied) (includes grille, side mirrors, door handles, windshield wipers, front & rear bumpers, clipless mounting) (requires #9288 inner fenders) (roll bar sold separately; choose #9262 chrome, 9262R black, or 9262X chrome with lights)
9230-BRWN	Body, Ford F-150 (1979), complete, brown (painted, decals applied) (includes grille, side mirrors, door handles, windshield wipers, front & rear bumpers, clipless mounting) (requires #9288 inner fenders) (roll bar sold separately; choose #9262 chrome, 9262R black, or 9262X chrome with lights)

6593	Distribution block, Pro Scale® Advanced Lighting Control System
8075	Door handles, left & right/ windshield wipers, left & right/ retainers (3)/ 1.6x5 BCS (self-tapping) (4) (fits #8010 or 9230 series bodies)
8070	Grille, Ford Bronco or F-150/ grille retainers (6)/ headlight housing (2)/ lens (2)/ 2.6x8 BCS (6)/ 2.5x6 BCS (2) (fits #8010 or 9230 series bodies)
8032R	Installation kit, Pro Scale® Advanced Lighting Control System, TRX-4® Ford Bronco (1979), Ford F-150 (1979), or Chevrolet K10 Truck (1979) (includes mount, reverse lights harness, hardware)
8036R	LED light set (contains headlights, tail lights, side marker lights, and distribution block) (fits #8010 or 9230 series bodies, requires #8028 power supply)
8035	LED light set, complete with power supply (contains headlights, tail lights, side marker lights, & distribution block) (fits #8010 body)
8035A	LED light set, complete with power supply (contains headlights, tail lights, side marker lights, & distribution block) (fits #8010 or 9230 series bodies)
8037	LED lights, high/low switch (for #8035 or #8036 LED light kits)
9263	Light bar, chrome (housing & lens only) (fits #9262 or 9262X roll bar)
8073	Mirrors, side, black (left & right)/ retainers (2)/ body clips (4) (fits #8010 or 9230 series bodies)
8073X	Mirrors, side, chrome (left & right)/ retainers (2)/ body clips (4) (fits #8010 or 9230 series bodies)
6592	Power module, Pro Scale® Advanced Lighting Control System (includes mount, communication cables, hardware)
6591	Pro Scale® Advanced Lighting Control System (includes power module & distribution block)
8035R	Pro Scale® LED light set, TRX-4® Ford Bronco (1979) or Ford F-150 (1979), complete with power module (contains headlights, tail lights, side marker lights, & distribution block) (fits #8010 or 9230 series bodies)
6594	Receiver communication cable, Pro Scale® Advanced Lighting Control System
9262X	Roll bar (assembled with LED lights)/ mounts (front (2), rear (left & right))/ 2.6x12mm BCS (self-tapping) (4) (fits #9212 or 9230 series bodies)
9262R	Roll bar (black)/ mounts (front (2), rear (left & right))/ 2.6x12mm BCS (self-tapping) (4) (fits #9212 or 9230 series bodies)
9262	Roll bar/ mounts (front (2), rear (left & right))/ 2.6x12mm BCS (self-tapping) (4) (fits #9212 or 9230 series bodies)
9231	Side trim, left & right (chrome)/ LED lens/ 2.6x8mm BCS (14)/ 2.6x10mm BCS (6) (fits #9230 body)
8076	Side trim, left & right (chrome)/ retainers/ LED lens/ 2.6x8 BCS (24) (fits #8010 series bodies)
9232	Tailgate panel/ tail light lens (left & right)/ tail light housing (left & right)/ 1.6x10mm BCS (self-tapping) (2) (fits #9230 body)

Body Accessories

1926	Antenna caps, vinyl (2)/ antenna spool
1726	Antenna, tube (1)/ vinyl antenna cap (1)/ wire retainer (1)
1834	Body Clips (12) (standard size)
1834A	Body clips, black (12) (standard size)
3934	Body clips, heavy duty (12)
3934A	Body clips, heavy duty (black) (12)
8215	Body mounts & posts, front & rear (complete set)
9228	Body mounts (front & rear)/ 3x10mm BCS (7) (fits #9212 body)
8115	Body posts, front & rear
4915	Body washers, foam adhesive (10)
2514	Decal sheet, racing sponsors
8081	Fender extensions (4)/ 3x8 flathead screws (24) (requires #8080 narrow inner fenders)
8072	Fenders, inner, front & rear (2 each)/ rock light covers (8)/ battery plate/ 3x8 flathead screws (4)
9288	Fenders, inner, front & rear (for clipless body mounting) (2 each)/ rock light covers (8)
9950	Official Team Traxxas® racing decal set(flag logo/ 6-color)

Bumpers & Skidplates

8234	Bumper D-Rings, grey (front or rear)/ 2.0x12 CS (4)
8234R	Bumper D-rings, red (front or rear)/ 2.0x12 CS (4)
8067X	Bumper mounts, front & rear/ bumper mount, rear (offset)
8237	Bumper mounts, front & rear/ screw pins (4)
8124	Bumper, front (178mm wide)/ winch/ 2.6x8 BCS (1)
8069X	Bumper, front (chrome)/ bumper mount (2)/ 3x10 BCS (2)
8235	Bumper, front/ winch/ 2.6x8 BCS (1)
8236	Bumper, rear
8125	Bumper, rear (176mm wide)
8068	Bumper, rear (chrome)/ bumper mount/ 3x10 BCS (2)
9237	Extender, skid plate
8066	Push bar, bumper (chrome) (fits #8069 bumper)
8238	Skidplate/ lower gear cover

Chassis & Attachments

8215	Body mounts & posts, front & rear (complete set)
8224	Box, receiver (sealed)/ wire cover/ foam pads/ silicone grease/ 3x8 BCS (5)/ 2.5x8 CS (2)
8058	Chassis conversion kit, TRX-4® (long to short wheelbase) (includes rear upper & lower suspension links, front & rear inner fenders, short female half shaft, battery tray, 3x8mm FCS (4))
8057	Chassis conversion kit, TRX-4® (short to long wheelbase) (includes rear upper & lower suspension links, front & rear shock towers, long female half shaft)
8220	Chassis rails, 448mm (steel) (left & right)
9229	Chassis rails, 480mm (steel) (left & right)
8081	Fender extensions (4)/ 3x8 flathead screws (24) (requires #8080 narrow inner fenders)
8080	Fenders, inner (narrow), front & rear (2 each)/ rock light covers (8)/ battery plate/ body mount/ 3x8 flat-head screws (4)/ 2.5x6 CS (10)
8080X	Fenders, inner (narrow), front & rear (2 each)/ rock light covers (8)/ battery plate/ body mount/ 3x8 flat-head screws (4)/ 2.5x6 CS (10) (for clipless body mounting)
8072	Fenders, inner, front & rear (2 each)/ rock light covers (8)/ battery plate/ 3x8 flathead screws (4)
9288	Fenders, inner, front & rear (for clipless body mounting) (2 each)/ rock light covers (8)
8218	Floor pans, left & right
8224X	Receiver box cover (for use only with #8224 receiver box & #2260 BEC)/ foam pads/ seals/ silicone grease
8219	Rock sliders, left & right
8225	Seal kit, receiver box (includes o-ring, seals, and silicone grease)
8240X	Servo mount, 2-speed/ servo mount, T-Lock/ wire clips
8239	Servo mount, steering/ chassis crossmember
8216	Shock towers, front & rear (left & right)
8226	Tray, battery

Differential Components

8281	Carrier, differential/ differential slider/ T-Lock fork
8280A	Differential cover, front or rear (black)
8280X	Differential cover, front or rear (chrome plated)
8280-GRN	Differential cover, front or rear (green)
8280	Differential cover, front or rear (grey)
8280R	Differential cover, front or rear (red)
8195	Differential, locking, front and rear (assembled) (includes T-Lock cables and servos)
8282	Gear set, differential (output gears (2), spider gears (4), spider gear shaft (2))
8295	Output drive, transmission or differential (pin retainer (1)/ drive cup (1)/ drive ball (1)/ drive pin (1)/ 3x10 screw pin (1)/ cross pin (black) (1) 3x6 BCS with threadlock (1))
8279	Ring gear, differential/ pinion gear, differential
8279R	Ring gear, differential/ pinion gear, differential (machined)
8287	Ring gear, differential/ pinion gear, differential (overdrive, machined)
8288	Ring gear, differential/ pinion gear, differential (underdrive, machined)
8297	Spool/ differential housing plug/ e-clip/ 2.5x8mm BCS (with threadlock) (4)

Driveline Components

9250	Driveshaft extension kit, center (includes internal splined, xx-long (2), internal splined, medium (1) and internal splined, short (1))
8250	Half shafts, center (internal splined, front (2) & internal splined, rear (2)/ external splined (2)/ pin retainer (4)) (plastic parts only)
8255A	Stub axle, extended thread (portal drive) (2)
8269	Wheel hubs, 12mm hex (2)/ stub axle pins (2) (steel)
8269X	Wheel hubs, 12mm hex, 6061-T6 aluminum (blue-anodized) (4)/ 3x10 screw pin (4)
8269A	Wheel hubs, 12mm hex, 6061-T6 aluminum (charcoal gray-anodized) (4)/ 3x10 screw pin (4)
8269G	Wheel hubs, 12mm hex, 6061-T6 aluminum (green-anodized) (4)/ 3x10 screw pin (4)
8269R	Wheel hubs, 12mm hex, 6061-T6 aluminum (red-anodized) (4)/ 3x10 screw pin (4)

Hardware

1552	3x8mm Hex Cap Screws (6)/ Washers (6)/ Wrench (1)
1834	Body Clips (12) (standard size)
1834A	Body clips, black (12) (standard size)
3934	Body clips, heavy duty (12)
3934A	Body clips, heavy duty (black) (12)
4859	CS 3x10 flathead (hex drive)
8167X	Hardware kit, stainless steel, beadlock rings (contains stainless steel hardware for 4 wheels)

8298	Hardware kit, stainless steel, TRX-4® (contains all stainless steel hardware used on TRX-4®)	8148	Cable, T-lock, extra long (193mm) (for use with TRX-4® Long Arm Lift Kit)
8151	Hardware kit, stainless steel, TRX-4® High Lift Kit (contains all stainless steel hardware used on TRX-4® High Lift Kit)	9283	Cable, T-lock, rear (185mm)
5476X	Hex wrenches; 1.5mm, 2mm, 2.5mm, 3mm, 2.5 ball	8150	Driveshaft extension kit, center (includes internal splined, x-long (2), internal splined, long (1) and internal splined, medium (1)) (for use with TRX-4® Long Arm Lift Kit)
1747P	Nuts, 4mm flanged nylon locking (aluminum, pink anodized) (4)	8140	Long arm lift kit, TRX-4®, complete
3647	Nuts, 4mm flanged nylon locking (steel, serrated) (8)	8140X	Long arm lift kit, TRX-4®, complete (includes blue powder coated links, blue-anodized shocks)
8347	Nuts, 4mm flanged nylon locking, serrated (black) (10)	8140-GRN	Long arm lift kit, TRX-4®, complete (includes green powder coated links, green-anodized shocks)
1747R	Nuts, aluminum, flanged, serrated (4mm) (blue-anodized) (4)	8140R	Long arm lift kit, TRX-4®, complete (includes red powder coated links, red-anodized shocks)
1747G	Nuts, aluminum, flanged, serrated (4mm) (green-anodized) (4)	8149	Rod ends, extended (standard (4), angled (4))/ hollow balls (8) (for use with TRX-4® Long Arm Lift Kit)
1747T	Nuts, aluminum, flanged, serrated (4mm) (orange-anodized) (4)	8141	Servo mount, steering (for use with TRX-4® Long Arm Lift Kit)
1747A	Nuts, aluminum, flanged, serrated (4mm) (red-anodized) (4)	8161	Shock shaft, 3x57mm (GTS) (2) (includes bump stops) (for use with TRX-4® Long Arm Lift Kit)
1985	PTFE-coated Washers, 5x8x0.5mm (20) (use with ball bearings)	8160X	Shocks, GTS, aluminum (blue-anodized) (assembled without springs) (4) (for use with #8140X TRX-4® Long Arm Lift Kit)
8221	Screw pin, 3x10mm (6)	8160-GRN	Shocks, GTS, aluminum (green-anodized) (assembled without springs) (4) (for use with #8140 TRX-4® Long Arm Lift Kit)
9236	Screws, 1.6x10mm button-head, self-tapping (hex drive) (6)	8160R	Shocks, GTS, aluminum (red-anodized) (assembled without springs) (4) (for use with #8140R TRX-4® Long Arm Lift Kit)
2523	Screws, 2.5x10 countersunk machine (hex drive) (6)	8160	Shocks, GTS, silver aluminum (assembled without springs) (4) (for use with #8140 TRX-4® Long Arm Lift Kit)
3229	Screws, 2.5x10mm cap-head machine (hex drive) (6)	8153	Springs, shock, long (natural finish) (GTS) (0.29 rate, white stripe) (for use with TRX-4® Long Arm Lift Kit)
3236	Screws, 2.5x12mm cap-head machine (6)	8154	Springs, shock, long (natural finish) (GTS) (0.39 rate, orange stripe) (for use with TRX-4® Long Arm Lift Kit)
2618	Screws, 2.5x16mm cap-head machine (6)	8155	Springs, shock, long (natural finish) (GTS) (0.47 rate) (included with TRX-4® Long Arm Lift Kit)
3215	Screws, 2.5x6mm cap-head machine (hex drive) (6)	8156	Springs, shock, long (natural finish) (GTS) (0.54 rate, green stripe) (for use with TRX-4® Long Arm Lift Kit)
2524	Screws, 2.5x8 countersunk machine (hex drive) (6)	8157	Springs, shock, long (natural finish) (GTS) (0.62 rate, blue stripe) (for use with TRX-4® Long Arm Lift Kit)
2617	Screws, 2.5x8mm button-head machine (hex drive) (6)	8146X	Steering link, 5x117mm (1)/ drag link, 5x60mm (1)/ panhard link, 5x63mm (blue powder coated steel) (assembled with hollow balls) (for use with #8140X TRX-4® Long Arm Lift Kit)
3965	Screws, 2.5x8mm cap-head machine (6)	8146R	Steering link, 5x117mm (1)/ drag link, 5x60mm (1)/ panhard link, 5x63mm (red powder coated steel) (assembled with hollow balls) (for use with #8140R TRX-4® Long Arm Lift Kit)
8299	Screws, 2.6x12mm button-head, self-tapping (hex drive) (6)	8144X	Suspension link, front upper, 5x68mm (1) (blue powder coated steel) (assembled with hollow balls) (for use with #8140X TRX-4® Long Arm Lift Kit)
8167	Screws, 2x10mm cap-head, self-tapping (hex drive) (10)	8144R	Suspension link, front upper, 5x68mm (1) (red powder coated steel) (assembled with hollow balls) (for use with #8140R TRX-4® Long Arm Lift Kit)
2564	Screws, 2x8mm cap-head machine (hex drive) (6)	8144	Suspension link, front upper, 5x68mm (1) (steel) (assembled with hollow balls) (for use with #8140 TRX-4® Long Arm Lift Kit)
2577	Screws, 3x10mm button-head machine (hex drive) (6)	8143	Suspension links, front lower (2) (5x104mm, steel) (assembled with hollow balls) (for use with #8140 TRX-4® Long Arm Lift Kit)
2578	Screws, 3x12mm button-head machine (hex drive) (6)	8143X	Suspension links, front lower, blue (2) (5x104mm, powder coated steel) (assembled with hollow balls) (for use with #8140X TRX-4® Long Arm Lift Kit)
2579	Screws, 3x15mm button-head machine (hex drive) (6)	8143R	Suspension links, front lower, red (2) (5x104mm, powder coated steel) (assembled with hollow balls) (for use with #8140R TRX-4® Long Arm Lift Kit)
2591	Screws, 3x23mm button-head machine (hex drive) (6)	8145	Suspension links, rear lower (2) (5x115mm, steel) (assembled with hollow balls) (for use with #8140 TRX-4® Long Arm Lift Kit)
2581	Screws, 3x25mm button-head machine (hex drive) (6)	8145X	Suspension links, rear lower, blue (2) (5x115mm, powder coated steel) (assembled with hollow balls) (for use with #8140X TRX-4® Long Arm Lift Kit)
2616	Screws, 3x27mm button-head machine (hex drive) (6)	8145R	Suspension links, rear lower, red (2) (5x115mm, powder coated steel) (assembled with hollow balls) (for use with #8140R TRX-4® Long Arm Lift Kit)
2582	Screws, 3x30mm button-head machine (hex drive) (6)	8142	Suspension links, rear upper (2) (5x115mm, steel) (assembled with hollow balls) (for use with #8140 TRX-4® Long Arm Lift Kit)
2575	Screws, 3x6mm button-head machine (hex drive) (6)	8142X	Suspension links, rear upper, blue (2) (5x115mm, powder coated steel) (assembled with hollow balls) (for use with #8140X TRX-4® Long Arm Lift Kit)
3932	Screws, 3x6mm flat-head machine (hex drive) (6)	8142R	Suspension links, rear upper, red (2) (5x115mm, powder coated steel) (assembled with hollow balls) (for use with #8140R TRX-4® Long Arm Lift Kit)
2576	Screws, 3x8mm button-head machine (hex drive) (6)	8172	Tires & wheels, assembled (Method Race Wheels® 105 Beadlock 2.2" black chrome beadlock wheels, Canyon Trail 5.3x2.2" tires, foam inserts) (1 left, 1 right)
3931	Screws, 3x8mm flat-head machine (hex drive) (6)	8184	Tires & wheels, assembled, glued (2.2" classic chrome wheels, Canyon Trail 5.3x2.2" tires, foam inserts) (2)/ center caps (front (2), rear (2)) (requires #8255A extended thread stub axle)
3933	Screws, 4x16mm button-head machine (hex drive) (6)	8181-BLUE	Tires & wheels, assembled, glued (TRX-4® Sport 2.2" gray, blue beadlock style wheels, Canyon Trail 5.3x2.2" tires) (2)
		8181-GRN	Tires & wheels, assembled, glued (TRX-4® Sport 2.2" gray, green beadlock style wheels, Canyon Trail 5.3x2.2" tires) (2)

LED Light Accessories

8031	3-in-1 wire harness, LED light kit
8089	4-in-2 wire harness, LED light kit
6589	Distribution block, LED light set
6593	Distribution block, Pro Scale® Advanced Lighting Control System
8032R	Installation kit, Pro Scale® Advanced Lighting Control System, TRX-4® Ford Bronco (1979), Ford F-150 (1979), or Chevrolet K10 Truck (1979) (includes mount, reverse lights harness, hardware)
8036R	LED light set (contains headlights, tail lights, side marker lights, and distribution block) (fits #8010 or 9230 series bodies, requires #8028 power supply)
8028	LED lights, power supply (regulated, 3V, 0.5-amp)/ 3-in-1 wire harness
8026X	LED rock light kit, TRX-4®/TRX-6™ (requires #8028 power supply and #8018, #8072, or #8080 inner fenders)
9263	Light bar, chrome (housing & lens only) (fits #9262 or 9262X roll bar)
6592	Power module, Pro Scale® Advanced Lighting Control System (includes mount, communication cables, hardware)
6591	Pro Scale® Advanced Lighting Control System (includes power module & distribution block)
8035R	Pro Scale® LED light set, TRX-4® Ford Bronco (1979) or Ford F-150 (1979), complete with power module (contains headlights, tail lights, side marker lights, & distribution block) (fits #8010 or 9230 series bodies)
6594	Receiver communication cable, Pro Scale® Advanced Lighting Control System
9262X	Roll bar (assembled with LED lights)/ mounts (front (2), rear (left & right))/ 2.6x12mm BCS (self-tapping) (4) (fits #9212 or 9230 series bodies)
9262R	Roll bar (black)/ mounts (front (2), rear (left & right))/ 2.6x12mm BCS (self-tapping) (4) (fits #9212 or 9230 series bodies)
9262	Roll bar/ mounts (front (2), rear (left & right))/ 2.6x12mm BCS (self-tapping) (4) (fits #9212 or 9230 series bodies)

Long Arm Lift Kit

8162X	Body, GTS shock, long (aluminum, blue-anodized) (1) (for use with #8140X TRX-4® Long Arm Lift Kit)	8184	Tires & wheels, assembled, glued (2.2" classic chrome wheels, Canyon Trail 5.3x2.2" tires, foam inserts) (2)/ center caps (front (2), rear (2)) (requires #8255A extended thread stub axle)
8162R	Body, GTS shock, long (aluminum, red-anodized) (1) (for use with #8140R TRX-4® Long Arm Lift Kit)	8181-BLUE	Tires & wheels, assembled, glued (TRX-4® Sport 2.2" gray, blue beadlock style wheels, Canyon Trail 5.3x2.2" tires) (2)
8162	Body, GTS shock, long (silver aluminum) (1) (for use with #8140 TRX-4® Long Arm Lift Kit)	8181-GRN	Tires & wheels, assembled, glued (TRX-4® Sport 2.2" gray, green beadlock style wheels, Canyon Trail 5.3x2.2" tires) (2)
8147	Cable, T-lock (medium) (for use with TRX-4® Long Arm Lift Kit)		

- 8181-RED Tires & wheels, assembled, glued (TRX-4® Sport 2.2" gray, red beadlock style wheels, Canyon Trail 5.3x2.2" tires) (2)
- 8181 Tires & wheels, assembled, glued (TRX-4® Sport 2.2" wheels, Canyon Trail 5.3x2.2" tires) (2)
- 8170 Tires, Canyon Trail 5.3x2.2"/ foam inserts (2)
- 8171 Wheels, 2.2", Method Race Wheels® 105 Beadlock (black chrome, beadlock) (beadlock rings sold separately)
- 8171A Wheels, 2.2", Method Race Wheels® 105 Beadlock (charcoal gray, beadlock) (beadlock rings sold separately)
- 8180 Wheels, TRX-4® Sport 2.2 (2)
- 8180-BLUE Wheels, TRX-4® Sport 2.2 (gray, blue beadlock style) (2)
- 8180-GRN Wheels, TRX-4® Sport 2.2 (gray, green beadlock style) (2)
- 8180-RED Wheels, TRX-4® Sport 2.2 (gray, red beadlock style) (2)

- 8856 Winch, TRX-4® and TRX-6® (requires #8857 wireless remote)
- 8857 Wireless remote, winch, TRX-4® and TRX-6®

Radio System, Batteries & Chargers

- 2823X 1400mah 11.1v 3-Cell 25C LiPo Battery
- 2820X 2200mah 7.4v 2-Cell 25C LiPo Battery
- 2849X 4000mah 11.1v 3-Cell 25C LiPo Battery
- 2872X 5000mah 11.1v 3-Cell 25C LiPo Battery
- 2842X 5000mah 7.4v 2-Cell 25C LiPo Battery
- 2843X 5800mah 7.4v 2-Cell 25C LiPo Battery
- 2869X 7600mah 7.4v 2-Cell 25C LiPo Battery
- 2914 Battery, Power Cell AA Alkaline (4)
- 2976 AC to DC adapter
- 2938X Adapter, Traxxas® iD® LiPo battery (adapts Traxxas® iD® batteries to separate balance ports)
- 1726 Antenna, tube (1)/ vinyl antenna cap (1)/ wire retainer (1)
- 2943 Battery charge indicators, green (4), grey (4), blue (4)
- 6548 Battery door, TQ 2.4 transmitter (replacement for #6516, 6517 transmitter)
- 8222 Battery strap (for use with 2200mAh 2-cell and 1400mAh 3-cell LiPo batteries)
- 2923X Battery, Power Cell, 3000mAh (NiMH, 7-C flat, 8.4V)
- 2940X Battery, Series 3 Power Cell, 3300mAh (NiMH, 7-C flat, 8.4V)
- 2950X Battery, Series 4 Power Cell, 4200mAh (NiMH, 7-C flat, 8.4V)
- 2960X Battery, Series 5 Power Cell, 5000mAh (NiMH, 7-C flat, 8.4V)
- 2983 Battery/charger completer pack (includes #2969 2-amp NiMH peak detecting AC charger (1), #2923X 3000mAh 8.4V 7-cell NiMH iD® battery (1))
- 2992 Battery/charger completer pack (includes #2970 iD® charger (1), #2843X 5800mAh 7.4V 2-cell 25C LiPo iD® battery (1))
- 2994 Battery/charger completer pack (includes #2970 iD® charger (1), #2849X 4000mAh 11.1v 3-Cell 25C LiPo iD® battery (1))
- 2991 Battery/charger completer pack (includes #2972 Dual iD charger (1), #2869X 7600mAh 7.4V 2-cell 25C LiPo iD® Battery (2))
- 2262 BEC, complete (12.6 volts (3s LiPo) maximum input voltage) (includes receiver box cover and seals)
- 2975 Charger, D/C, 4 amp (6 - 7 cell, 7.2 - 8.4 volt, NiMH)
- 2972 Charger, EZ-Peak Dual, 100W, NiMH/LiPo with iD Auto Battery Identification
- 2973 Charger, EZ-Peak Live Dual, 200W, NiMH/LiPo with iD Auto Battery Identification
- 2970 Charger, EZ-Peak Plus, 4 amp, NiMH/LiPo with iD Auto Battery Identification
- 2971 Charger, EZ-Peak® Live, 100W, NiMH/LiPo with iD® Auto Battery Identification
- 2981 Charger, EZ-Peak® Plus 4s, 8 amp, NiMH/LiPo with iD® Auto Battery Identification
- 6525 Communication link, telemetry expander
- 6512 Cover plate, Traxxas® Link Bluetooth® module
- 2978 Fuse, D/C charger, 5A (2) (for #2974, 2975, 2977)
- 2064A Gear set (for 2065A waterproof sub-micro servo)
- 2064R Gear set, metal (for 2065R waterproof sub-micro servo)
- 2072X Gear set, metal (for 2070, 2075 servos)
- 2252 Gear set, metal (for 2250, 2255 servos)
- 2272 Gear set, metal (for 2270 waterproof servo)
- 2072R Gear set, metal, high-speed (for 2070, 2075 servos)
- 2968X LiPo cell voltage checker/balancer (includes #2938X adapter for Traxxas® iD® batteries)
- 2968 LiPo cell voltage checker/balancer (requires #2938X adapter for Traxxas® iD® batteries)
- 6561 Mount, telemetry expander
- 6535 Mount, temperature sensor (electric motors)/ wire tie/ thermal pad
- 6533 Receiver, micro, TQi 2.4GHz with telemetry & TSM® (5-channel)
- 6552 Seal kit, expander box (includes o-ring, seals, and silicone grease)
- 6526 Sensor, auto-detectable, temperature
- 6527 Sensor, auto-detectable, voltage
- 6521 Sensor, temperature and voltage (long)
- 2254 Servo case, aluminum (middle) (blue-anodized) (for 2250 servo)
- 2253 Servo case, aluminum (middle) (red-anodized) (for 2255 servo)
- 2251 Servo case, plastic (top, middle, bottom)/ gaskets/ hardware (for 2250, 2255 servos)
- 2271 Servo case/ gaskets (for 2270 waterproof servo)
- 2063A Servo case/gaskets (for 2065A waterproof sub-micro servo)
- 2063R Servo case/gaskets (for 2065R metal gear, waterproof, sub-micro servo)
- 2063X Servo case/gaskets (for 2065X metal gear, waterproof, sub-micro servo)
- 2075R Servo, digital high-speed, metal gear (ball bearing), waterproof
- 2250 Servo, digital high-torque 330 coreless, metal gear (ball bearing), waterproof (#2262 external BEC and #8247X metal servo horn recommended for optimal performance)
- 2255 Servo, digital high-torque 400 brushless, metal gear (ball bearing), waterproof (#2262 external BEC and #8247X metal servo horn recommended for optimal performance)
- 2270 Servo, digital high-torque, metal gear (ball bearing), waterproof
- 2075X Servo, digital high-torque, metal gear (ball bearing), waterproof
- 2065A Servo, sub-micro, waterproof
- 2065R Servo, sub-micro, waterproof, metal gear
- 3025 XL-5HV 3s Electronic Speed Control, waterproof (low-voltage detection, fwd/rev/brake)
- 2261 Y-harness, BEC

Motors & Electronics

- 1926 Antenna caps, vinyl (2)/ antenna spool
- 1726 Antenna, tube (1)/ vinyl antenna cap (1)/ wire retainer (1)
- 2262 BEC, complete (12.6 volts (3s LiPo) maximum input voltage) (includes receiver box cover and seals)
- 2064A Gear set (for 2065A waterproof sub-micro servo)
- 2064R Gear set, metal (for 2065R waterproof sub-micro servo)
- 2072X Gear set, metal (for 2070, 2075 servos)
- 2252 Gear set, metal (for 2250, 2255 servos)
- 2272 Gear set, metal (for 2270 waterproof servo)
- 2072R Gear set, metal, high-speed (for 2070, 2075 servos)
- 8290X Motor mount plate, 6061-T6 aluminum (blue-anodized)
- 8290A Motor mount plate, 6061-T6 aluminum (charcoal gray-anodized)
- 8290G Motor mount plate, 6061-T6 aluminum (green-anodized)
- 8290R Motor mount plate, 6061-T6 aluminum (red-anodized)
- 3975R Motor, Titan 550, reverse rotation (21-turns/ 14 volts) (1)
- 8290 Plate, motor/ upper spur gear cover
- 2254 Servo case, aluminum (middle) (blue-anodized) (for 2250 servo)
- 2253 Servo case, aluminum (middle) (red-anodized) (for 2255 servo)
- 2251 Servo case, plastic (top, middle, bottom)/ gaskets/ hardware (for 2250, 2255 servos)
- 2271 Servo case/ gaskets (for 2270 waterproof servo)
- 2063A Servo case/gaskets (for 2065A waterproof sub-micro servo)
- 2063R Servo case/gaskets (for 2065R metal gear, waterproof, sub-micro servo)
- 2063X Servo case/gaskets (for 2065X metal gear, waterproof, sub-micro servo)
- 5669 Servo horn (with built-in spring and hardware) (for Summit locking differential)
- 2075R Servo, digital high-speed, metal gear (ball bearing), waterproof
- 2250 Servo, digital high-torque 330 coreless, metal gear (ball bearing), waterproof (#2262 external BEC and #8247X metal servo horn recommended for optimal performance)
- 2255 Servo, digital high-torque 400 brushless, metal gear (ball bearing), waterproof (#2262 external BEC and #8247X metal servo horn recommended for optimal performance)
- 2270 Servo, digital high-torque, metal gear (ball bearing), waterproof
- 2075X Servo, digital high-torque, metal gear (ball bearing), waterproof
- 2065A Servo, sub-micro, waterproof
- 2065R Servo, sub-micro, waterproof, metal gear
- 3025 XL-5HV 3s Electronic Speed Control, waterproof (low-voltage detection, fwd/rev/brake)
- 2261 Y-harness, BEC

Pro Scale® Winch & Accessories

- 8867 Bumper, front, winch, medium (includes bumper mount, D-Rings, fairlead, hardware) (fits TRX-4® 1979 Bronco and 1979 Blazer with 8855 winch) (217mm wide)
- 8859 Fairlead, winch
- 8870X Fairlead, winch, aluminum (blue-anodized) (use with front bumpers #8865, 8866, 8867, 8869, or 9224)
- 8870A Fairlead, winch, aluminum (gray-anodized) (use with front bumpers #8865, 8866, 8867, 8869, or 9224)
- 8870G Fairlead, winch, aluminum (green-anodized) (use with front bumpers #8865, 8866, 8867, 8869, or 9224)
- 8870T Fairlead, winch, aluminum (orange-anodized) (use with front bumpers #8865, 8866, 8867, 8869, or 9224)
- 8870R Fairlead, winch, aluminum (red-anodized) (use with front bumpers #8865, 8866, 8867, 8869, or 9224)
- 8862 Gearmotor, winch
- 8863 Hook, winch (steel)/ line retainer/ washer
- 8858 Housings (front & rear), winch/ decal
- 8864X Line, winch (blue)
- 8864 Line, winch (gray)
- 8864R Line, winch (red)
- 8860 Spool shaft assembly, winch
- 8861 Spool, winch
- 8855 Winch kit with wireless controller, TRX-4® and TRX-6®

- 2255 Servo, digital high-torque 400 brushless, metal gear (ball bearing), waterproof (#2262 external BEC and #8247X metal servo horn recommended for optimal performance)
- 2075X Servo, digital high-torque, metal gear (ball bearing), waterproof
- 2270 Servo, digital high-torque, metal gear (ball bearing), waterproof
- 2065A Servo, sub-micro, waterproof
- 2065R Servo, sub-micro, waterproof, metal gear
- 6553X Telemetry Expander 2.0 and GPS module 2.0, TQi radio system
- 6550X Telemetry expander 2.0, TQi radio system (for use only with #6551X GPS module)
- 6551X Telemetry GPS module 2.0, TQi radio system (for use only with #6550X telemetry expander)
- 6509R TQi 2.4 GHz High Output radio system, 2-channel, Traxxas® Link enabled, TSM® (2-ch transmitter, 5-ch micro receiver)
- 6507R TQi 2.4 GHz High Output radio system, 4-channel with Traxxas® Link Bluetooth® module, TSM® (4-ch transmitter, 5-ch micro receiver)
- 6530 Transmitter, TQi Traxxas® Link enabled, 2.4GHz high output, 4-channel (transmitter only)
- 6511 Traxxas® Link Bluetooth® module
- 2261 Y-harness, BEC

- 8260R Shocks, GTS, red-anodized (assembled with spring retainers) (2)
- 8260 Shocks, GTS, silver aluminum (assembled with spring retainers) (2)

Slipper Clutch Components

- 8292 Input shaft/ output shaft (transmission)
- 8286 Output shafts (transfer case), front & rear
- 8254 Rebuild kit, slipper clutch (steel disc (2)/ friction insert (2)/ 4.0mm NL (1)/ spring washers (2))
- 8249 Slipper eliminator plate

Springs

- 8041 Springs, shock (GTS) (front) (0.45 rate) (2)
- 8040 Springs, shock (GTS) (rear) (0.54 rate) (2)
- 8042 Springs, shock (natural finish) (GTS) (0.22 rate, yellow stripe) (2)
- 8043 Springs, shock (natural finish) (GTS) (0.30 rate, white stripe) (2)
- 8044 Springs, shock (natural finish) (GTS) (0.39 rate, orange stripe) (2)
- 8045 Springs, shock (natural finish) (GTS) (0.61 rate, blue stripe) (2)

Spur Gears & Pinion Gears

- 6746 Gear, 10-T pinion (32-p) (steel) (fits 3mm shaft)/ set screw
- 6747 Gear, 11-T pinion (32-p) (steel) (fits 3mm shaft)/ set screw
- 3942X Gear, 12-T pinion (32-p), heavy duty (machined, hardened steel) (fits 3mm shaft)/ set screw
- 3943X Gear, 13-T pinion (32-p), heavy duty (machined, hardened steel) (fits 3mm shaft)/ set screw
- 3944X Gear, 14-T pinion (32-p), heavy duty (machined, hardened steel) (fits 3mm shaft)/ set screw
- 3945X Gear, 15-T pinion (32-p), heavy duty (machined, hardened steel) (fits 3mm shaft)/ set screw
- 3946X Gear, 16-T pinion (32-p), heavy duty (machined, hardened steel) (fits 3mm shaft)/ set screw
- 3947X Gear, 17-T pinion (32-p), heavy duty (machined, hardened steel) (fits 3mm shaft)/ set screw
- 3948X Gear, 18-T pinion (32-p), heavy duty (machined, hardened steel) (fits 3mm shaft)/ set screw
- 3949X Gear, 19-T pinion (32-p), heavy duty (machined, hardened steel) (fits 3mm shaft)/ set screw
- 3950X Gear, 20-T pinion (32-p), heavy duty (machined, hardened steel) (fits 3mm shaft)/ set screw
- 3951X Gear, 21-T pinion (32-p), heavy duty (machined, hardened steel) (fits 3mm shaft)/ set screw
- 3952X Gear, 22-T pinion (32-p), heavy duty (machined, hardened steel) (fits 3mm shaft)/ set screw
- 6745 Gear, 9-T pinion (32-p) (steel) (fits 3mm shaft)/ set screw
- 8052 Spur gear, 39-tooth (32-pitch)
- 8053 Spur gear, 45-tooth (32-pitch)

Ready-To-Race Model

- 92046-4 TRX-4® High Trail Edition™ with 1979 Ford® F-150® Truck Body: 4WD Electric Truck with TQi™ Traxxas Link™ Enabled 2.4GHz Radio System

Scale Details

- 8120X Expedition rack, complete (includes traction boards, shovel, axe, jack, fire extinguisher, fuel cans, & mounting hardware) (fits #8111 or #8111R body)
- 8422-BLK Fire extinguisher, black (2)
- 8422 Fire extinguisher, red (2)
- 8022T Fuel canisters (black) (2)/ screw pin
- 8022R Fuel canisters (blue) (2)/ screw pin
- 8022-GRN Fuel canisters (green) (2)/ screw pin
- 8022 Fuel canisters (red) (2)/ screw pin
- 8022X Fuel canisters (white) (2)/ screw pin
- 8022A Fuel canisters (yellow) (2)/ screw pin
- 8023 Jack (1)/ 2x8 BCS (1)
- 8023T Jack (black) (1)/ 2x8 BCS (1)
- 8122-BLK Shovel/ axe (black)/ accessory mount/ mounting hardware
- 8122 Shovel/ axe/ accessory mount/ mounting hardware
- 8121X Traction boards, blue/ mounting hardware
- 8121G Traction boards, green/ mounting hardware
- 8121A Traction boards, yellow/ mounting hardware
- 8121 Traction boards/ mounting hardware

Shock Oil

- 5031 Oil, shock (20 wt, 200 cSt, 60cc) (silicone)
- 5032 Oil, shock (30 wt, 350 cSt, 60cc) (silicone)
- 5033 Oil, shock (40 wt, 500 cSt, 60cc) (silicone)
- 5034 Oil, shock (50 wt, 600 cSt, 60cc) (silicone)
- 5035 Oil, shock (60 wt, 700 cSt, 60cc) (silicone)
- 5036 Oil, shock (70 wt, 900 cSt, 60cc) (silicone)
- 5037 Oil, shock (80 wt, 1,000 cSt, 60cc) (silicone)
- 5029 Shock oil bottle (60cc) (for mixing shock oil)
- 5038X Shock oil set (includes 20 wt, 30 wt, 40 wt, 50 wt, 60 wt, 70 wt, & 80 wt premium shock oils with spinning carousel rack)
- 5038 Spinning carousel rack

Shocks (GTS)

- 8266A Body, GTS shock (aluminum, blue-anodized) (1)
- 8266G Body, GTS shock (aluminum, green-anodized) (1)
- 8266R Body, GTS shock (aluminum, red-anodized) (1)
- 8266 Body, GTS shock (aluminum, silver-anodized) (1)
- 8266X Body, GTS shock (hard-anodized, PTFE-coated aluminum) (1)
- 8264 Caps & spring retainers, GTS shocks (upper cap (2)/ hollow balls (4)/ bottom cap (2)/ upper retainer (2)/ lower retainer (2))
- 8274 Hollow ball set, complete, TRX-4® (aluminum, PTFE-coated)
- 5475 Multi-tool (plastic)
- 8261 Piston, damper (red) (4)/ e-clips (8)
- 8262 Rebuild kit, TRX-4® shocks (x-rings, o-rings, pistons, bushings, e clips, rod ends, and travel limiters)
- 8263 Shock shaft, 3x47mm (GTS) (2)
- 8263T Shock shaft, 3x47mm (GTS) (titanium nitride-coated) (2)
- 8260X Shocks, GTS hard-anodized, PTFE-coated aluminum bodies with TiN shafts (assembled with spring retainers) (2)
- 8260A Shocks, GTS, blue-anodized (assembled with spring retainers) (2)
- 8260G Shocks, GTS, green-anodized (assembled with spring retainers) (2)

Steering Components

- 8232 Caster blocks (portal drive), left & right
- 8232X Caster blocks, 6061-T6 aluminum (blue-anodized), left and right
- 8232A Caster blocks, 6061-T6 aluminum (charcoal gray-anodized), left and right
- 8232G Caster blocks, 6061-T6 aluminum (green-anodized), left and right
- 8232R Caster blocks, 6061-T6 aluminum (red-anodized), left and right
- 2072X Gear set, metal (for 2070, 2075 servos)
- 2072R Gear set, metal, high-speed (for 2070, 2075 servos)
- 8274 Hollow ball set, complete, TRX-4® (aluminum, PTFE-coated)
- 5355 Hollow ball, tall centered (2)/ tall offset hollow ball (2)/ bump steer adjustment shims; 3.5mm (2), 1.17mm (2)
- 8275 Rod end set, complete (standard (10), angled 10-degrees (8), offset (4))
- 8276 Rod ends (10)
- 8277 Rod ends, angled 10-degrees (8)
- 2742 Rod ends, long (6)/ hollow ball connectors (6)
- 8278 Rod ends, offset (4)
- 8247X Servo horn, steering, metal/ 3x14 BCS (1)
- 2075R Servo, digital high-speed, metal gear (ball bearing), waterproof
- 2250 Servo, digital high-torque 330 coreless, metal gear (ball bearing), waterproof
- 2255 Servo, digital high-torque 400 brushless, metal gear (ball bearing), waterproof
- 2075X Servo, digital high-torque, metal gear (ball bearing), waterproof
- 5529 Shim set, 3x7x1mm (2), 3x6x0.5mm (4), 3x7x2mm (2)/ hollow balls, captured (4)
- 8246 Steering link, 5x60mm (1)/ draglink, 5x117mm (1) (steel)
- 8243 Suspension link, front, 5x100mm (lower) (steel) (2)
- 8244 Suspension link, front, 5x63mm (upper) (steel) (2)
- 8245 Suspension link, rear, 5x121mm (upper or lower) (steel) (2)

Suspension Linkage

8058	Chassis conversion kit, TRX-4® (long to short wheelbase) (includes rear upper & lower suspension links, front & rear inner fenders, short female half shaft, battery tray, 3x8mm FCS (4))
8057	Chassis conversion kit, TRX-4® (short to long wheelbase) (includes rear upper & lower suspension links, front & rear shock towers, long female half shaft)
8274	Hollow ball set, complete, TRX-4® (aluminum, PTFE-coated)
5355	Hollow ball, tall centered (2)/ tall offset hollow ball (2)/ bump steer adjustment shims; 3.5mm (2), 1.17mm (2)
8275	Rod end set, complete (standard (10), angled 10-degrees (8), offset (4))
8276	Rod ends (10)
8277	Rod ends, angled 10-degrees (8)
2742	Rod ends, long (6)/ hollow ball connectors (6)
8278	Rod ends, offset (4)
5529	Shim set, 3x7x1mm (2), 3x6x0.5mm (4), 3x7x2mm (2)/ hollow balls, captured (4)
8243	Suspension link, front, 5x100mm (lower) (steel) (2)
8244	Suspension link, front, 5x63mm (upper) (steel) (2)
8248	Suspension link, rear, 5x109mm (upper or lower) (steel) (2)
8245	Suspension link, rear, 5x121mm (upper or lower) (steel) (2)

Team Traxxas Items

2514	Decal sheet, racing sponsors
9950	Official Team Traxxas® racing decal set(flag logo/ 6-color)
9909	Traxxas® racing banner, red & black (3x7 feet)

Tires & Wheels

8169T	Beadlock rings, black (1.9") (aluminum) (4)/ 2x10 CS (48)
8168T	Beadlock rings, black (2.2") (aluminum) (4)/ 2x10 CS (48)
8169X	Beadlock rings, blue (1.9") (aluminum) (4)/ 2x10 CS (48)
8168X	Beadlock rings, blue (2.2") (aluminum) (4)/ 2x10 CS (48)
8169G	Beadlock rings, green (1.9") (aluminum) (4)/ 2x10 CS (48)
8168G	Beadlock rings, green (2.2") (aluminum) (4)/ 2x10 CS (48)
8169R	Beadlock rings, red (1.9") (aluminum) (4)/ 2x10 CS (48)
8168R	Beadlock rings, red (2.2") (aluminum) (4)/ 2x10 CS (48)
8169	Beadlock rings, satin (1.9") (aluminum) (4)/ 2x10 CS (48)
8168	Beadlock rings, satin (2.2") (aluminum) (4)/ 2x10 CS (48)
8152	Center caps, wheel (satin chrome) (front (2), rear (2)) (requires #8255A extended thread stub axle)
1747P	Nuts, 4mm flanged nylon locking (aluminum, pink anodized) (4)
1747R	Nuts, aluminum, flanged, serrated (4mm) (blue-anodized) (4)
1747G	Nuts, aluminum, flanged, serrated (4mm) (green-anodized) (4)
1747T	Nuts, aluminum, flanged, serrated (4mm) (orange-anodized) (4)
1747A	Nuts, aluminum, flanged, serrated (4mm) (red-anodized) (4)
8174	Tires & wheels, assembled (Method Race Wheels® 105 Beadlock 1.9" black chrome beadlock wheels, Canyon Trail 4.6x1.9" tires, foam inserts) (1 left, 1 right)
8182	Tires & wheels, assembled (Method Race Wheels® 105 Beadlock 1.9" satin black chrome, blue beadlock style wheels, Canyon Trail 4.6x1.9" tires, foam inserts) (1 left, 1 right)
8166	Tires & wheels, assembled, glued (1.9" chrome wheels, Canyon Trail 4.6x1.9" tires) (2)/ center caps (2)/ decal sheet (requires #8255A extended thread stub axle)
8177	Tires & wheels, assembled, glued (1.9" chrome wheels, Canyon Trail 4.6x1.9" tires) (2)/ center caps (2)/ decal sheet (requires #8255A extended thread stub axle)
8166X	Tires & wheels, assembled, glued (1.9" chrome wheels, Canyon Trail 4.6x1.9" tires) (4)/ center caps (4)/ decal sheet (requires #8255A extended thread stub axle)
8183X	Tires & wheels, assembled, glued (1.9" classic chrome wheels, Canyon Trail 4.6x1.9" tires) (4)/ center caps (4)/ decal sheet (requires #8255A extended thread stub axle)
8159X	Tires & wheels, assembled, glued (2.2" chrome wheels, Canyon Trail 5.3 x 2.2" tires) (2)/ center caps (front (2), rear (2))/ decal sheet (requires #8255A extended thread stub axle)
8184	Tires & wheels, assembled, glued (2.2" classic chrome wheels, Canyon Trail 5.3x2.2" tires, foam inserts) (2)/ center caps (front (2), rear (2)) (requires #8255A extended thread stub axle)
8159	Tires & wheels, assembled, glued (2.2" satin chrome wheels, Canyon Trail 5.3 x 2.2" tires) (2)/ center caps (front (2), rear (2)) (requires #8255A extended thread stub axle)
8273	Tires & wheels, assembled, glued (Tactical 1.9" wheels, Canyon Trail 4.6x1.9" tires) (2)
8272X	Tires & wheels, assembled, glued (TRX-4® 1.9" satin beadlock wheels, Canyon Trail 4.6x1.9" tires) (2)
8272	Tires & wheels, assembled, glued (TRX-4® 1.9" wheels, Canyon Trail 4.6x1.9" tires) (2)
8179	Tires & wheels, assembled, glued (TRX-4® Sport 1.9" wheels, Canyon Trail 4.6x1.9" tires) (2)
8181-BLUE	Tires & wheels, assembled, glued (TRX-4® Sport 2.2" gray, blue beadlock style wheels, Canyon Trail 5.3x2.2" tires) (2)

8181-GRN	Tires & wheels, assembled, glued (TRX-4® Sport 2.2" gray, green beadlock style wheels, Canyon Trail 5.3x2.2" tires) (2)
8181-RED	Tires & wheels, assembled, glued (TRX-4® Sport 2.2" gray, red beadlock style wheels, Canyon Trail 5.3x2.2" tires) (2)
8172	Tires and wheels, assembled (Method 105 2.2™ black chrome beadlock wheels, Canyon Trail 5.3x2.2™ tires, foam inserts) (1 left, 1 right) (for use with TRX-4 Long Arm Lift Kit)
8181	Tires and wheels, assembled, glued (TRX-4® Sport 2.2™ wheels, Canyon Trail 5.3x2.2™ tires) (2) (for use with TRX-4 Long Arm Lift Kit)
8270	Tires, Canyon Trail 4.6x1.9" (S1 compound)/ foam inserts (2)
8170	Tires, Canyon Trail 5.3x2.2™/ foam inserts (2) (for use with TRX-4 Long-Arm Lift Kit)
8269	Wheel hubs, 12mm hex (2)/ stub axle pins (2) (steel)
8269X	Wheel hubs, 12mm hex, 6061-T6 aluminum (blue-anodized) (4)/ 3x10 screw pin (4)
8269A	Wheel hubs, 12mm hex, 6061-T6 aluminum (charcoal gray-anodized) (4)/ 3x10 screw pin (4)
8269G	Wheel hubs, 12mm hex, 6061-T6 aluminum (green-anodized) (4)/ 3x10 screw pin (4)
8269R	Wheel hubs, 12mm hex, 6061-T6 aluminum (red-anodized) (4)/ 3x10 screw pin (4)
8165	Wheels, 1.9", chrome (2)/ center caps (2)/ decal sheet (requires #8255A extended thread stub axle)
8175	Wheels, 1.9", chrome (2)/ center caps (2)/ decal sheet (requires #8255A extended thread stub axle)
8173	Wheels, 1.9", Method Race Wheels® 105 Beadlock (black chrome, beadlock) (beadlock rings sold separately)
8173A	Wheels, 1.9", Method Race Wheels® 105 Beadlock (charcoal gray, beadlock) (beadlock rings sold separately)
8158X	Wheels, 2.2", chrome (2)/ center caps (front (2), rear (2)) (requires #8255A extended thread stub axle)
8158	Wheels, 2.2", satin chrome (2)/ center caps (front (2), rear (2)) (requires #8255A extended thread stub axle)
8171	Wheels, Method 105 2.2" (black chrome, beadlock) (beadlock rings sold separately) (for use with TRX-4 Long Arm Lift Kit)
8171A	Wheels, Method 105 2.2" (charcoal gray, beadlock) (beadlock rings sold separately) (for use with TRX-4 Long Arm Lift Kit)
8180	Wheels, TRX-4 Sport 2.2 (2) (for use with TRX-4 Long Arm Lift Kit)
8271	Wheels, TRX-4® 1.9 (2)
8271X	Wheels, TRX-4® 1.9 (satin beadlock) (2)
8178	Wheels, TRX-4® Sport 1.9 (2)
8180-BLUE	Wheels, TRX-4® Sport 2.2 (gray, blue beadlock style) (2)
8180-GRN	Wheels, TRX-4® Sport 2.2 (gray, green beadlock style) (2)
8180-RED	Wheels, TRX-4® Sport 2.2 (gray, red beadlock style) (2)
8268	Wheels, TRX-4® Tactical 1.9 (2)

Transmission Components

8283	Cable, T-lock (front)
8284	Cable, T-lock (rear)
9283	Cable, T-lock, rear (185mm)
8195	Differential, locking, front and rear (assembled) (includes T-Lock cables and servos)
8289	Drive hub, 2-speed/ shift dog/ shift fork/ 2-speed linkage
8293X	Gear set, transmission, metal (includes 18T, 30T input gears, 36T output gear, 2x9.8 pins (5))
8291	Gearbox housing (includes main housing, front housing, & cover)
8285	Gears, transfer case (3)
5041	Grease, premium high performance (20cc)
8292	Input shaft/ output shaft (transmission)
8290X	Motor mount plate, 6061-T6 aluminum (blue-anodized)
8290A	Motor mount plate, 6061-T6 aluminum (charcoal gray-anodized)
8290G	Motor mount plate, 6061-T6 aluminum (green-anodized)
8290R	Motor mount plate, 6061-T6 aluminum (red-anodized)
8295	Output drive, transmission or differential (pin retainer (1) drive cup (1)/ drive ball (1)/ drive pin (1)/ 3x10 screw pin (1)/ cross pin (black) (1) 3x6 BCS with threadlock (1))
8294	Output gear, high range, 24T (metal)
8286	Output shafts (transfer case), front & rear
8290	Plate, motor/ upper spur gear cover
8249	Slipper eliminator plate
8296	Transmission gears, single speed, metal
8196	Two speed conversion kit

Traxxas Tools

3433X	Body reamer (aluminum handle)
3433	Body reamer (plastic handle)
3436	Cap, body reamer
3432	Scissors, curved tip
3431	Scissors, straight tip

- 8712 Speed Bit Essentials Set, hex and nut driver, 7-piece, includes premium handle (medium), travel pouch, hex drivers (straight: 1.5mm, 2.0mm, 2.5mm) and nut drivers (5.0mm, 5.5mm, 7.0mm, and 8.0mm), 1/4" drive
- 8720 Speed bit handle, large (overmolded)
- 8721 Speed bit handle, medium (one piece)
- 8722 Speed bit handle, premium (rubber overmold)
- 8710 Speed Bit Master Set, hex and nut driver, 13-piece, includes premium handle (medium), travel pouch, hex drivers (straight: 1.5mm, 2.0mm, 2.5mm, 3.0mm), (ball-end: 2.0mm, 2.5mm, 3.0mm), and nut drivers (4.0mm, 4.5mm, 5.0mm, 5.5mm, 7.0mm, 8.0mm), 1/4" drive
- 8711 Speed Bit Master Set, hex driver, 7-piece straight and ball end, includes premium handle (medium), travel pouch, hex drivers (straight: 1.5mm, 2.0mm, 2.5mm, 3.0mm) (ball end: 2.0mm, 2.5mm, 3.0mm), 1/4" drive
- 8719 Speed Bit Master Set, nut driver, 6-piece, includes premium handle (medium), travel pouch, and nut drivers (4.0mm, 4.5mm, 5.0mm, 5.5mm, 7.0mm, 8.0mm), 1/4" drive
- 8716 Speed Bit Set, hex driver, 2-piece ball-end (2.0mm, 2.5mm), 1/4" drive
- 8716X Speed Bit Set, hex driver, 3-piece ball-end (2.0mm, 2.5mm, 3.0mm) 1/4" drive
- 8715 Speed Bit Set, hex driver, 3-piece straight (1.5mm, 2.0mm, 2.5mm), 1/4" drive
- 8715X Speed Bit Set, hex driver, 4-piece straight (1.5mm, 2.0mm, 2.5mm, 3.0mm), 1/4" drive
- 8714 Speed Bit Set, screwdriver, 3-piece straight (3mm slotted, #1 Phillips, and #2 Phillips bits), 1/4" drive
- 2748R Tool set (includes 1.5mm hex wrench / 2.0mm hex wrench / 2.5mm hex wrench/ 4-way wrench/ 8mm & 4mm wrench/ U-joint wrench)
- 3415 Tool set with pouch (includes 1.5mm, 2.0mm, 2.5mm, 3.0mm, 3.5mm, 4mm drivers/4mm, 5mm, 5.5mm, 7mm, and 8mm nut drivers/ 2mm, 3mm, and 4mm slotted screwdrivers/ #00 Phillips, #0 Phillips, and #1 Phillips screwdrivers/ 4mm and 8mm wrenches/ driver handle)

TRX-4® Traxx®

- 8889 Bearing retainers, inner (2)/ outer (2)
- 8890 Drive wheel (1)
- 8885 Shock mounts (frame, left (2), frame, right (2))/ portal mounts (1 each, front (left & right), rear (left & right))
- 8888 Spring (4)
- 8887 Stub axle (1)
- 8886 Stub axle nut (4)
- 8891 Tension wheels (6)/ road wheels (4)
- 8881 Traxx®, front, left (assembled) (requires #8887 stub axle, #7061 GTR shock, & #8895 rubber track)
- 8882 Traxx®, front, right (assembled) (requires #8887 stub axle, #7061 GTR shock, & #8895 rubber track)
- 8883 Traxx®, rear, left (assembled) (requires #8887 stub axle, #7061 GTR shock, & #8896 rubber track)
- 8884 Traxx®, rear, right (assembled) (requires #8887 stub axle, #7061 GTR shock, & #8896 rubber track)
- 8880 Traxx®, TRX-4® (4) (complete set, front & rear)
- 8895 Treads, All-Terrain, TRX-4® Traxx® (front, left or right) (rubber) (1)
- 8896 Treads, All-Terrain, TRX-4® Traxx® (rear, left or right) (rubber) (1)

If you have questions or need technical assistance, call Traxxas at:

1-888-TRAXXAS

(1-888-872-9927) (U.S. residents only)

For orders, calls outside the U.S., and other information, call 972-549-3000, or fax to 972-549-3011 e-mail Traxxas at support@Traxxas.com

TRAXXAS.COM